



Hotel  
Vier Jahreszeiten  
Kempinski

MÜNCHEN

Unforgettable Events at the  
Hotel Vier Jahreszeiten Kempinski Munich



*Kempinski*

HOTELIERS SINCE 1897



## Welcome to the

**HOTEL VIER JAHRESZEITEN KEMPINSKI MUNICH**

Dear Event Planner,

I am delighted that you are interested in the Kempinski Hotel Vier Jahreszeiten Munich. Two years ago, we renovated the hotel's banqueting area in great detail and are now able to offer you events at the highest level. A special highlight is 'Die Küche München', our event kitchen, where spectacular kitchen parties take place on a regular basis.

I am confident that we will find the perfect venue for your function and, along with our Groups & Events Team, will be at your beck and call!

Yours sincerely,

Axel Ludwig  
General Manager  
Hotel Vier Jahreszeiten Kempinski Munich





# Content

## *Facts & Figures* 08–09

|  |       |
|--|-------|
| Location & Overview<br>Hotel Vier Jahreszeiten<br>Kempinski Munich | 08–09 |
|--|-------|

## *Event facilities* 12–33

### CONFERENCE & BANQUETING ROOMS 12–29

|                       |       |
|-----------------------|-------|
| Maximilian Saal       |       |
| • I: 50–180 persons   |       |
| • II: 60–200 persons  |       |
| • III: 30–100 persons | 16–17 |

|                         |       |
|-------------------------|-------|
| Marstall Saal           |       |
| • I & II: 20–80 persons | 18–19 |
| • III: 20–70 persons    | 20–21 |

|                       |    |
|-----------------------|----|
| Hofgarten             |    |
| • I: 12 persons       | 22 |
| • II/IV: 8–10 persons | 23 |
| • III: 25–50 persons  | 24 |
| • V: 15–30 persons    | 25 |

|                                   |       |
|-----------------------------------|-------|
| Die Küche München<br>• 25 persons | 26–27 |
|-----------------------------------|-------|

|  |       |
|--|-------|
| Jagdzimmer & Nymphenburger Zimmer<br>• 12–24 persons | 28–29 |
|--|-------|

|                      |       |
|----------------------|-------|
| Daily Delegate Rates | 30–31 |
|----------------------|-------|

|               |       |
|---------------|-------|
| Coffee Breaks | 32–33 |
|---------------|-------|

## *General Facts* 36–56

|                |       |
|----------------|-------|
| Rooms & Suites | 36–41 |
|----------------|-------|

|             |       |
|-------------|-------|
| Taste Force | 42–43 |
|-------------|-------|

|                                     |       |
|-------------------------------------|-------|
| Schwarzreiter Tagesbar & Restaurant | 44–45 |
|-------------------------------------|-------|

|   |       |
|---|-------|
| Munich's Most Beautiful Living Room<br>• Jahreszeiten Bar & Lobby<br>• Ian Baker – Pâtissier of the Year 2015 | 48–49 |
|---|-------|

|                   |       |
|-------------------|-------|
| Kempinski The Spa | 50–51 |
|-------------------|-------|

|                         |       |
|-------------------------|-------|
| Service & Ladies in Red | 52–53 |
|-------------------------|-------|

|                       |    |
|-----------------------|----|
| Your personal contact | 56 |
|-----------------------|----|





**JOINT EXPERIENCES**  
*Strengthen Team Spirit!*

Incentives strengthen the relationship between business partners, clients and employees. Munich offers numerous opportunities to experience unforgettable moments together. We are delighted to advise you!



**FACTS & FIGURES**

*The Location*

At the very heart of Munich on one of the world's most famous boulevards, Munich's Maximilianstraße, lies the legendary Hotel Vier Jahreszeiten Kempinski Munich. It is surrounded by exclusive luxury boutiques, the Bavarian State Opera and numerous sights, bars and restaurants, all within easy walking distance.

**DISTANCES:**

- International Airport Franz-Joseph-Strauss: approx. 35km
- Allgäu Airport: approx. 115km
- Main train station: approx. 3km

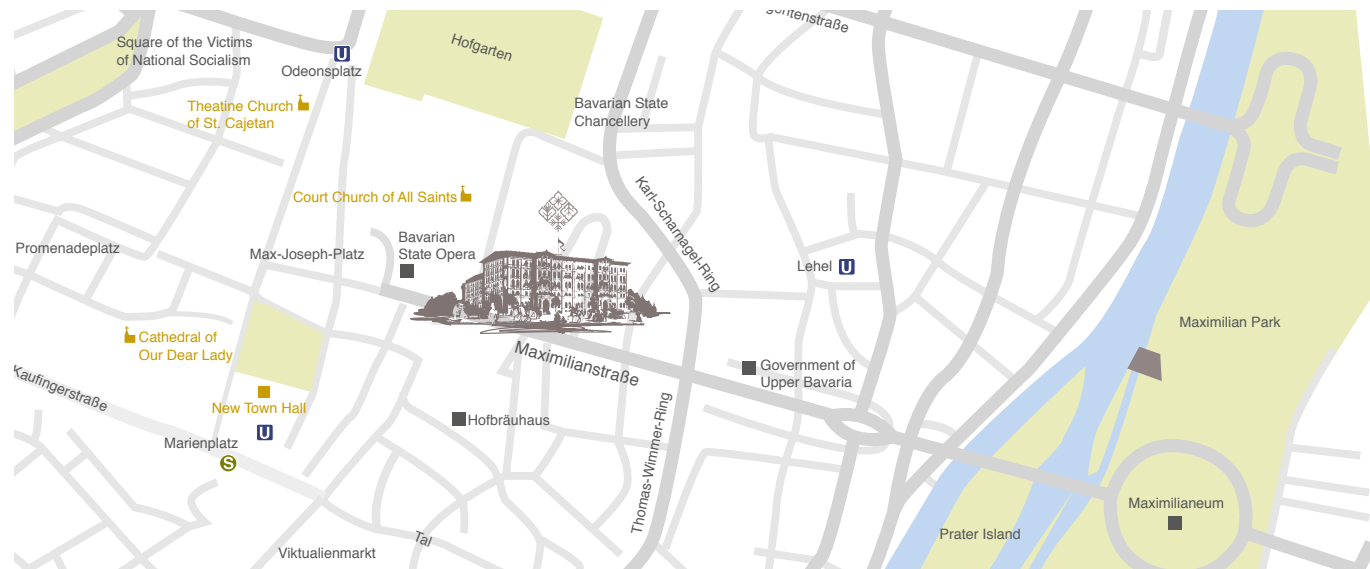

Central Location



View over the rooftops of Munich

*Overview Hotel Vier Jahreszeiten Kempinski Munich*

**NUMBER OF ROOMS AND SUITES**

- 167 Superior rooms
- 130 luxurious rooms and suites in various sizes, styles and furnishings
- Top suites: Royal Ludwig Suite, Presidential Suite, Penthouse Suite
- Air-conditioning
- Telephone
- Flat screen, HD and 3D TV with entertainment system
- Mini bar
- Complimentary iPad usage
- Modem, complimentary Wi-Fi and high-speed internet access

**HOTEL SERVICES**

- 24h concierge service
- 24h room service
- Laundry service
- Shoe shine service

- Underground parking
- Limousine service
- Valet parking

**KEMPINSKI THE SPA**

- Pool with sun deck (6th floor)
- Sauna
- Various spa and beauty treatments
- Steam bath
- Fitness Studio

**RESTAURANT AND BAR**

- Schwarzeiter Restaurant & Tagesbar, young Bavarian cuisine with regional produce
- Jahreszeiten Bar & Lobby

**LATEST BANQUETING EQUIPMENT**

- 11 banqueting rooms bathed in natural light and an events' kitchen 'Die Küche München'

- Maximilian ballroom for events for up to 600 guests and individualised LED ceiling lighting
- All function rooms are located on the ground floor with a separate entrance
- Complimentary Wi-Fi available throughout the hotel
- Fully equipped business centre
- State-of-the-art technical equipment

**SIGHTS**

- Bavarian State Opera
- Residence
- Bavarian castles
- Allianz Arena
- BMW World
- Olympic Park



Bavarian State Opera



Olympic Park

**HOW TO Get to Us:**





**THE VIER JAHRESZEITEN**  
*Food Truck*

For a company event or as a surprise for your clients, our Food Truck is a unique alternative for a coffee break or a small snack.





## OUR Conference & Banqueting Rooms

Eleven multi-functional function rooms bathed in natural light, along with complimentary Wi-Fi and an events kitchen will turn your event into an experience. The light flooded and generous atmosphere of the foyer, wall decorations which represent old masters, as well as the impressive glass dome make this event space unique.



Click here

EVENT MOVIE:

[www.kempinski.com/vierjahreszeiten](http://www.kempinski.com/vierjahreszeiten)

>> Meetings & Events >> Video

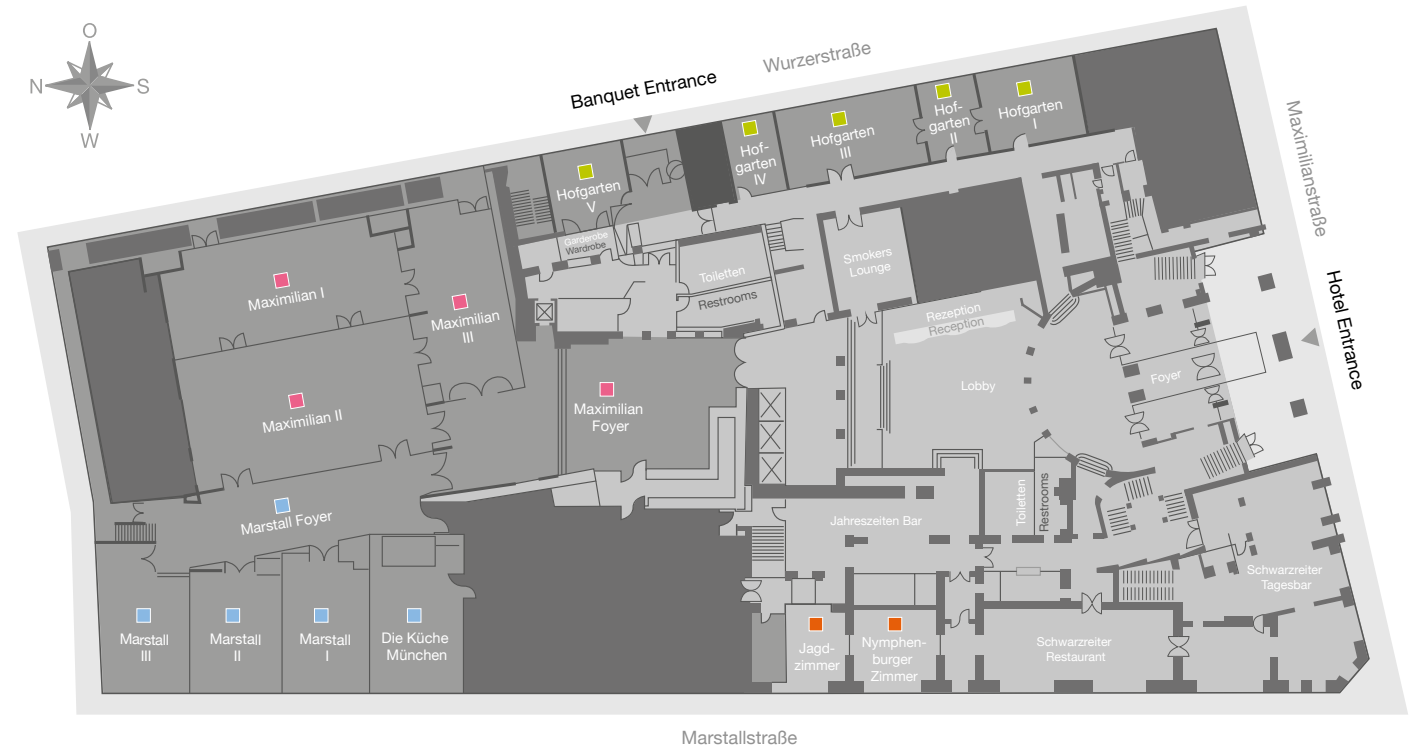

| ROOM                 | SQM | LENGTH - WIDTH<br>in m | HEIGHT<br>in m | THEATRE | CLASSROOM | BANQUET | CABARET | BOARDROOM | U-FORM | RECEPTION |
|----------------------|-----|------------------------|----------------|---------|-----------|---------|---------|-----------|--------|-----------|
| Maximilian I         | 170 | 20 x 8.5               | 3.4            | 180     | 80        | 90      | 55      | 50        | 50     | 140       |
| Maximilian II        | 215 | 20 x 11                | 4              | 200     | 120       | 120     | 72      | 60        | 60     | 220       |
| Maximilian I/II      | 385 | 20 x 19                |                | 440     | 230       | 220     | 132     | 70        | 90     | 400       |
| Maximilian III       | 120 | 8 x 15                 | 2.85           | 100     | 60        | 60      | 36      | 30        | 30     | 100       |
| Maximilian I/II/III  | 500 | 28 x 20                |                | 500     | 290       | 280     | 165     |           |        | 600       |
| Marstall I           | 82  | 11 x 7.5               | 2.85           | 80      | 45        | 40      | 25      | 20        | 20     | 70        |
| Marstall II          | 75  | 10 x 7.5               | 2.85           | 70      | 40        | 40      | 20      | 20        | 20     | 60        |
| Marstall III         | 82  | 11 x 7.5               | 2.85           | 80      | 45        | 40      | 25      | 20        | 20     | 70        |
| Marstall I/II/III    | 250 | 11 x 22.5              | 2.85           | 230     | 130       | 130     | 72      |           |        | 200       |
| Die Küche München    | 85  | 11.5 x 7.5             | 2.85           |         |           |         |         |           |        | 50        |
| Hofgarten I          | 40  | 5 x 8                  | 3.5            |         |           |         |         | 12        |        |           |
| Hofgarten II         | 24  | 5.2 x 4.5              | 3.5            |         |           | 10      |         | 10        |        | 20        |
| Hofgarten III        | 62  | 5.5 x 11.5             | 3.3            | 45      | 30        | 40      | 24      | 25        | 25     | 50        |
| Hofgarten IV         | 21  | 4.7 x 4.5              | 3.3            |         |           | 8       |         | 8         |        |           |
| Hofgarten III/IV     | 84  | 5.5 x 16               | 3.3            | 70      | 40        | 50      | 30      | 30        | 30     | 60        |
| Hofgarten V          | 35  | 6.5 x 5.5              | 3.3            | 25      | 18        |         |         | 15        | 15     | 30        |
| Nymphenburger Zimmer | 42  | 7 x 6                  | 3.3            |         |           |         |         | 24        |        |           |
| Jagdzimmer           | 25  | 5 x 5                  | 3.3            |         |           |         |         | 12        |        |           |







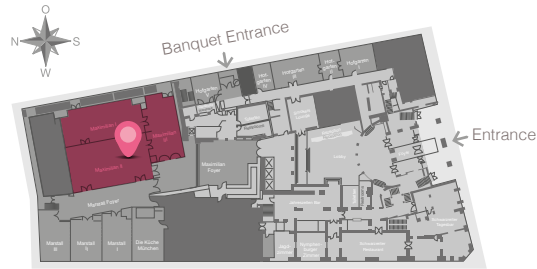

**NUMBER OF GUESTS PER ROOM**

- Maximilian I 50–180 persons
- Maximilian II 60–200 persons
- Maximilian III 30–100 persons



The Maximilian Ballroom is located on the ground floor and is light-filled due to its large windows. It is ideal for product presentations and especially for car launches.

# Maximilian I & II & III



**INFORMATION**

|  |                |         |
|--|----------------|---------|
|  | sqm            | 500     |
|  | length x width | 28 x 20 |
|  | height         |         |
|  | Theatre        | 500     |
|  | Classroom      | 290     |
|  | Banquet        | 280     |
|  | Cabaret        | 165     |
|  | Board Room     |         |
|  | U-Style        |         |
|  | Reception      | 600     |



From product presentations to gala dinners, the Maximilian Ballroom is suitable for any kind of event from 30 guests onwards.





**NUMBER OF GUESTS PER ROOM**

|             |               |
|-------------|---------------|
| Marstall I  | 20–80 persons |
| Marstall II | 20–70 persons |

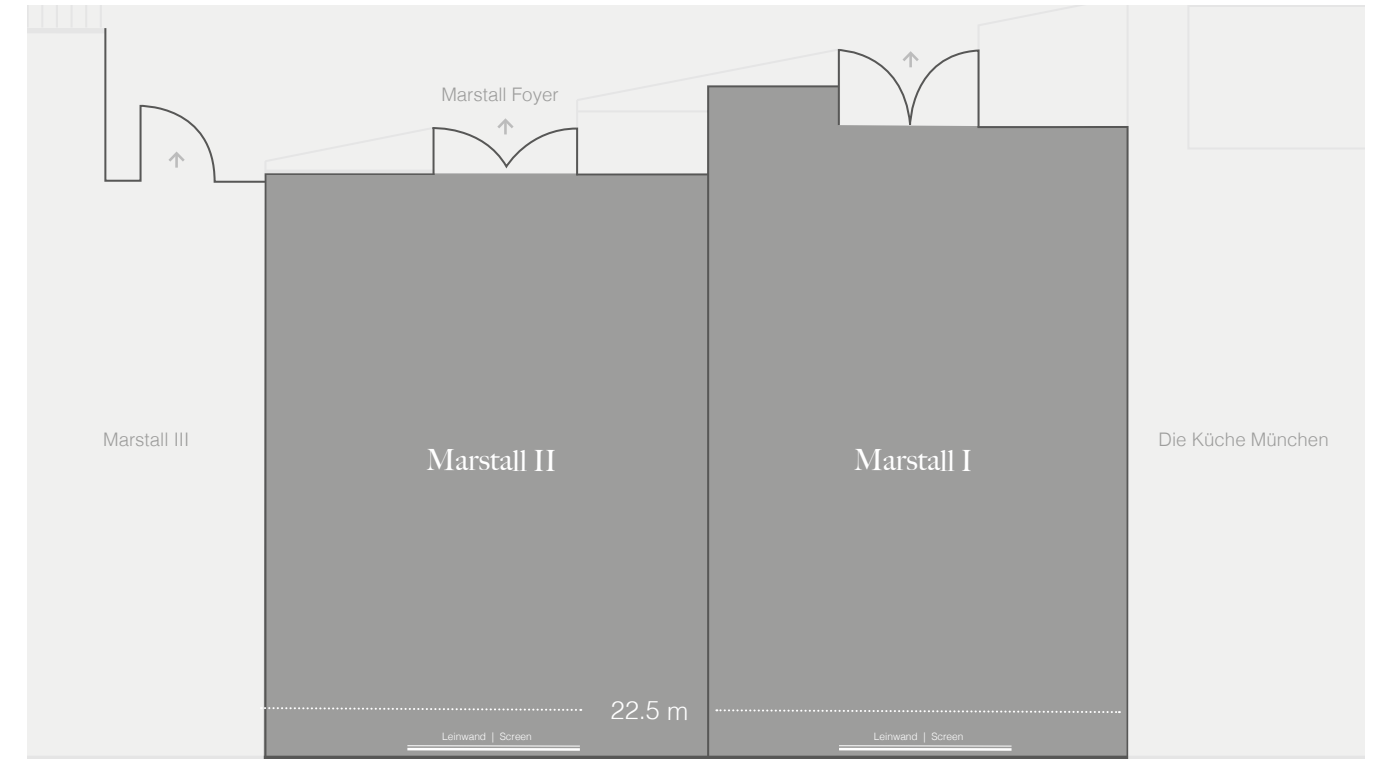

## Marstall I & II



**INFORMATION**

|  |                |          |
|--|----------------|----------|
|  | sqm            | 75       |
|  | length x width | 10 x 7.5 |
|  | height         | 2.85     |
|  | Theatre        | 150      |
|  | Classroom      | 85       |
|  | Banquet        | 80       |
|  | Cabaret        | 45       |
|  | Board Room     |          |
|  | U-Style        |          |
|  | Reception      | 130      |



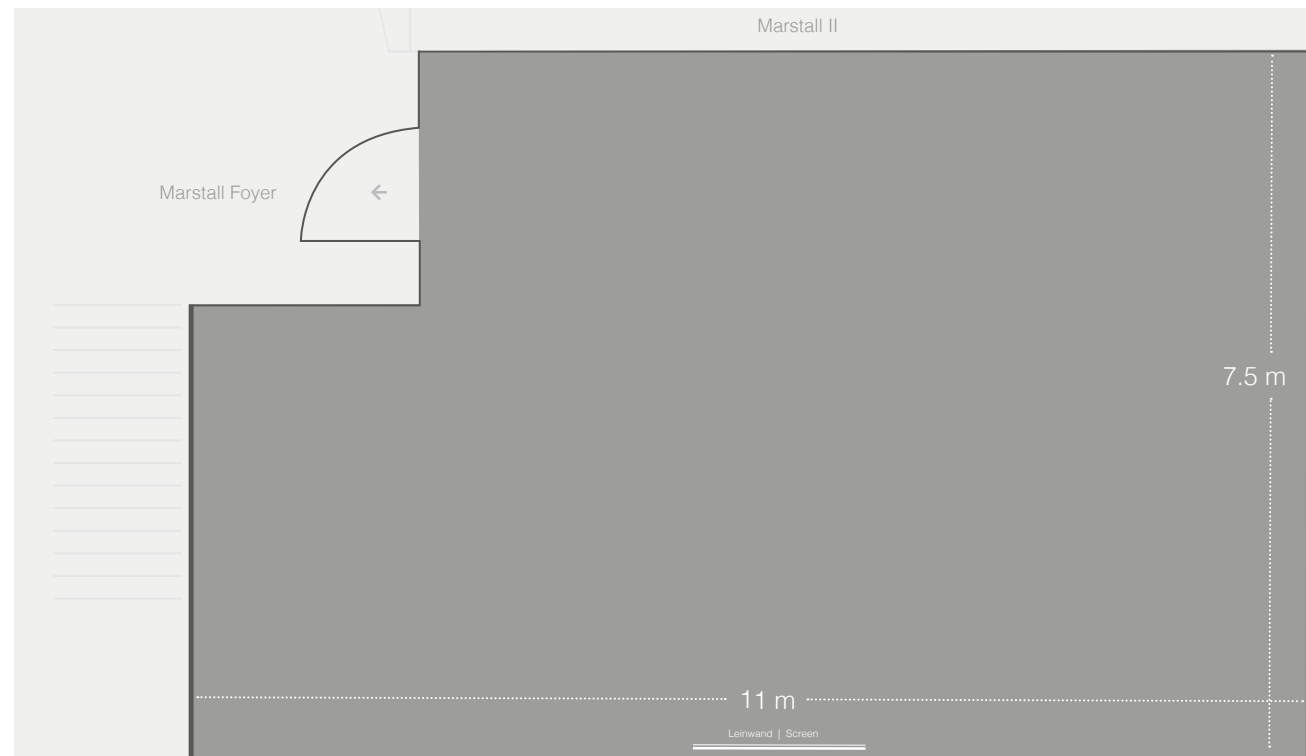
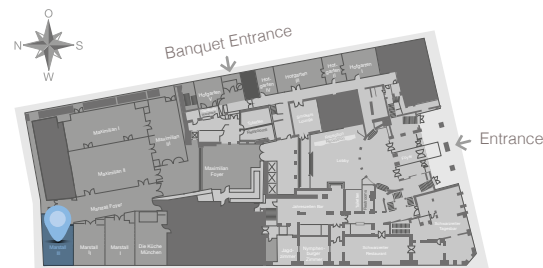

## Marstall III



### INFORMATION

|  |                |          |
|--|----------------|----------|
|  | sqm            | 82       |
|  | length x width | 11 x 7.5 |
|  | height         | 2.85     |
|  | Theatre        | 80       |
|  | Classroom      | 45       |
|  | Banquet        | 40       |
|  | Cabaret        | 25       |
|  | Board Room     | 20       |
|  | U-Style        | 20       |
|  | Reception      | 70       |





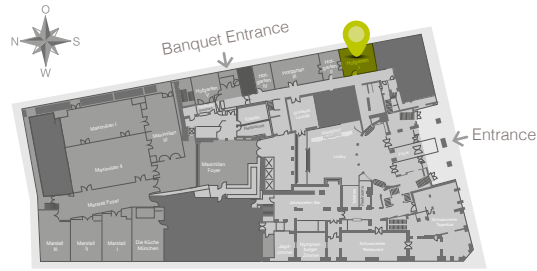

**NUMBER OF GUESTS PER ROOM**

|              |            |
|--------------|------------|
| Hofgarten II | 10 persons |
| Hofgarten IV | 8 persons  |

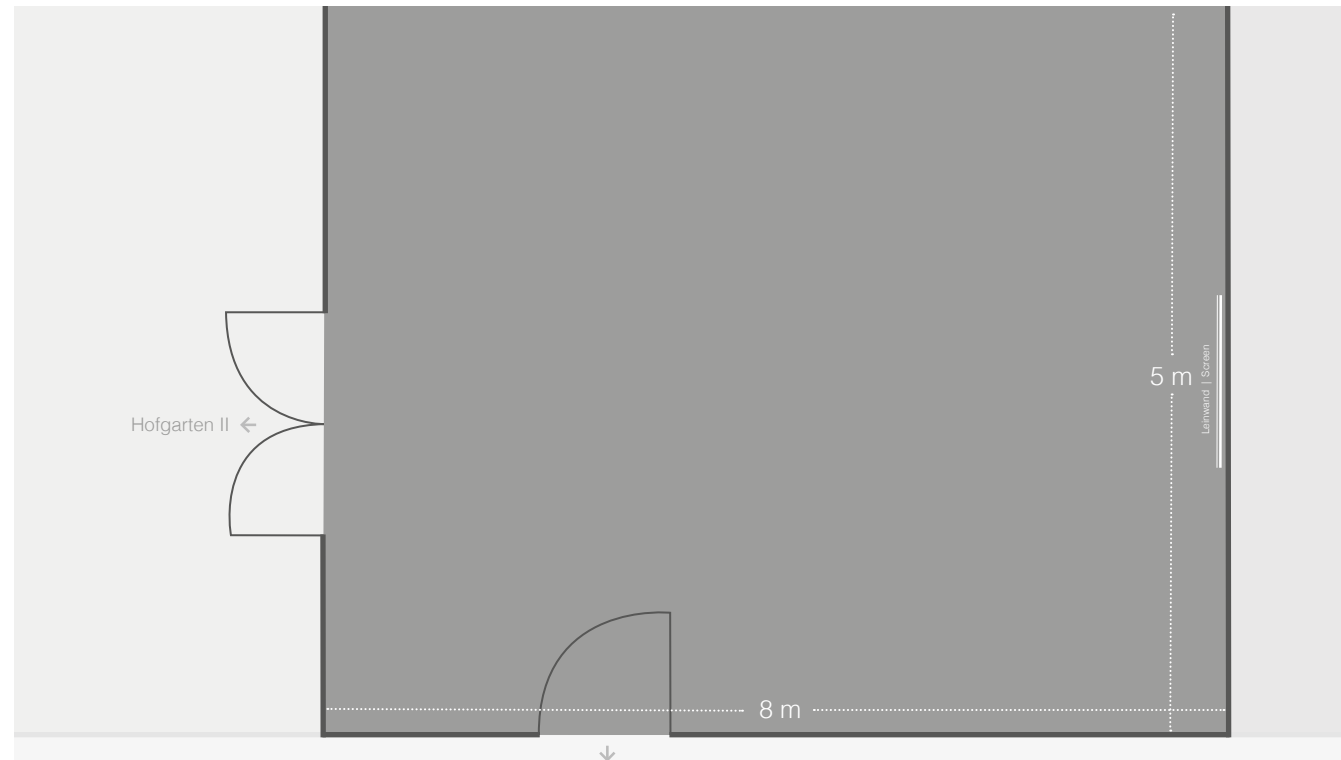

Hofgarten I



Hofgarten II/IV



**INFORMATION**

|                |            |    |
|----------------|------------|----|
| sqm            | 40         |    |
| length x width | 5 x 8      |    |
| height         | 3.5        |    |
|                | Theatre    |    |
|                | Classroom  |    |
|                | Banquet    |    |
|                | Cabaret    |    |
|                | Board Room | 12 |
|                | U-Style    |    |
|                | Reception  |    |



**INFORMATION**

|                |            |      |
|----------------|------------|------|
| sqm            | 21-24      |      |
| length x width | 5.2 x 4.5  |      |
| height         | 3.5        |      |
|                | Theatre    |      |
|                | Classroom  |      |
|                | Banquet    | 8-10 |
|                | Cabaret    |      |
|                | Board Room | 10   |
|                | U-Style    |      |
|                | Reception  | 20   |



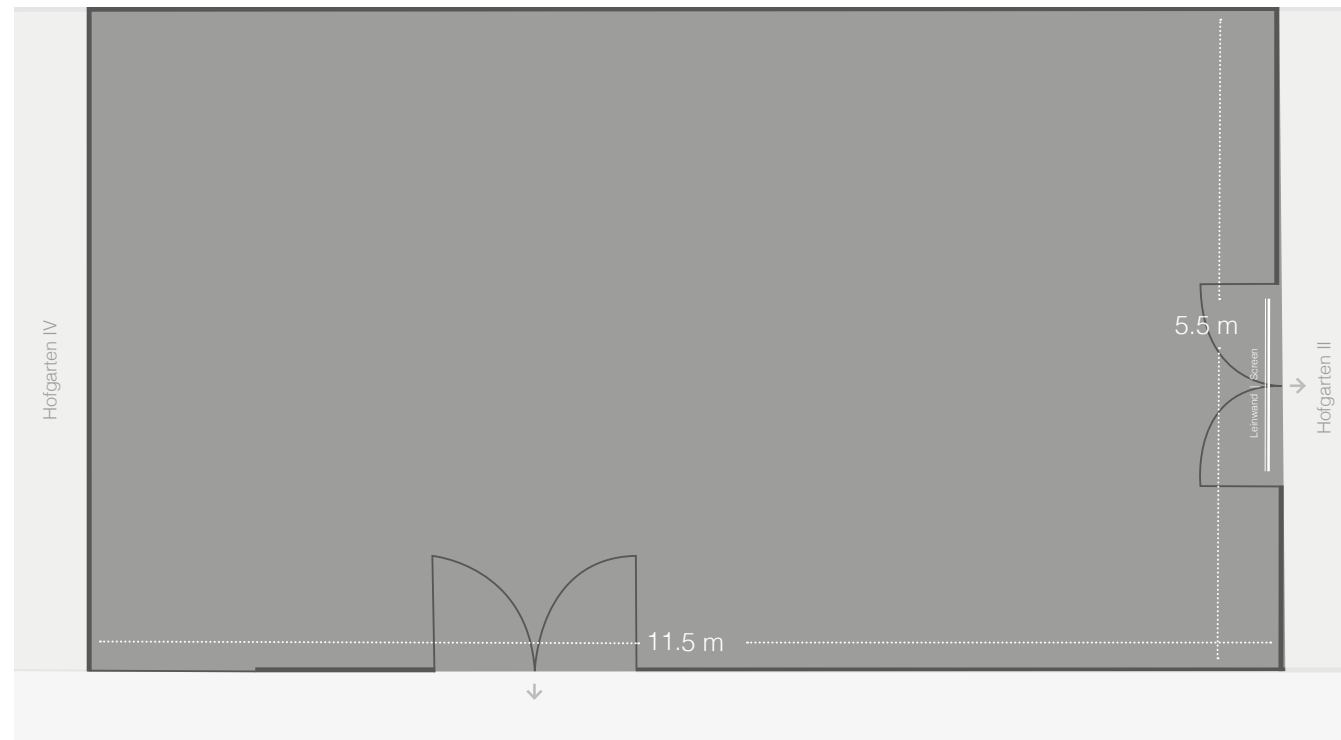
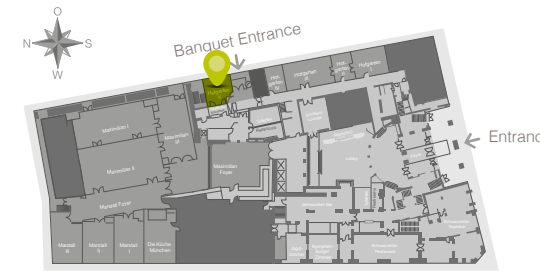
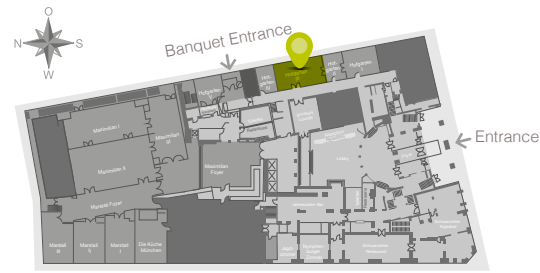

Hofgarten III



**INFORMATION**

|  |                |            |
|--|----------------|------------|
|  | sqm            | 62         |
|  | length x width | 5.5 x 11.5 |
|  | height         | 3.3        |
|  | Theatre        | 45         |
|  | Classroom      | 30         |
|  | Banquet        | 40         |
|  | Cabaret        | 24         |
|  | Board Room     | 25         |
|  | U-Style        | 25         |
|  | Reception      | 50         |

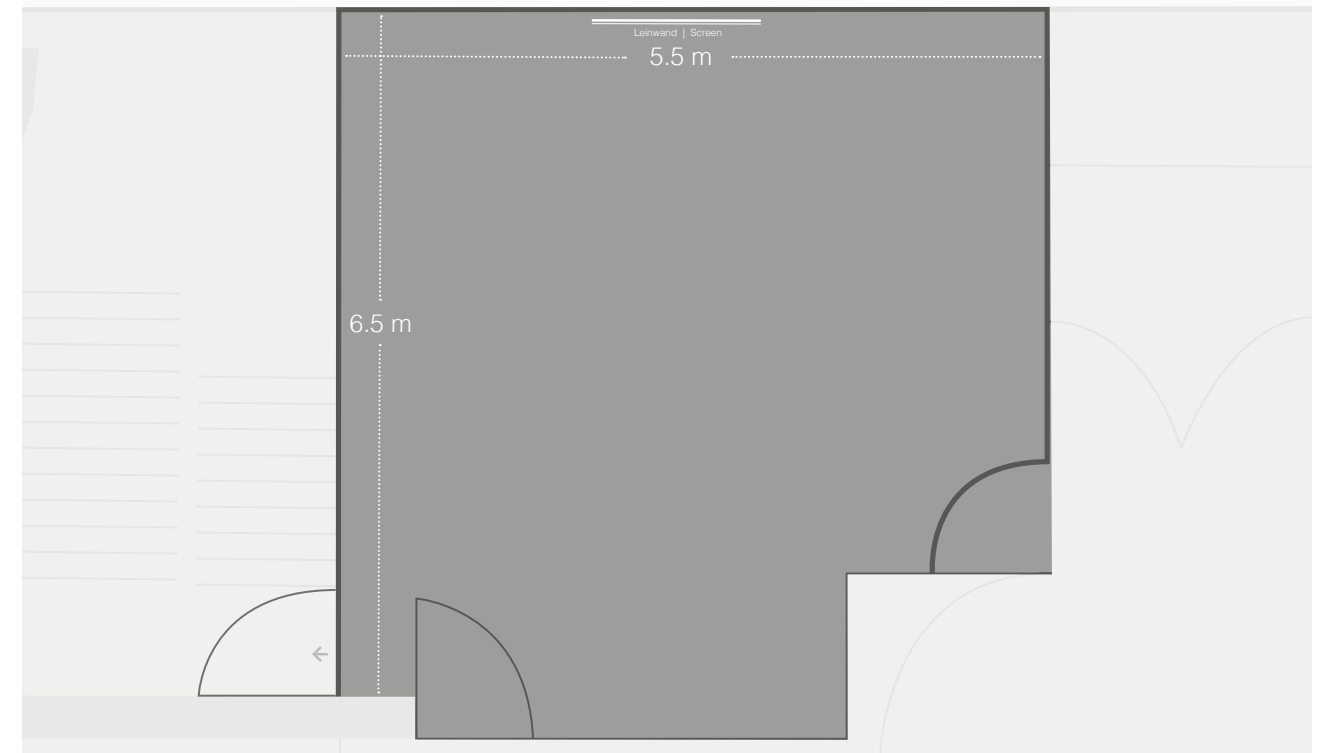

Hofgarten V



**INFORMATION**

|  |                |           |
|--|----------------|-----------|
|  | sqm            | 35        |
|  | length x width | 6.5 x 5.5 |
|  | height         | 3.3       |
|  | Theatre        | 25        |
|  | Classroom      | 18        |
|  | Banquet        |           |
|  | Cabaret        |           |
|  | Board Room     | 15        |
|  | U-Style        | 15        |
|  | Reception      | 30        |



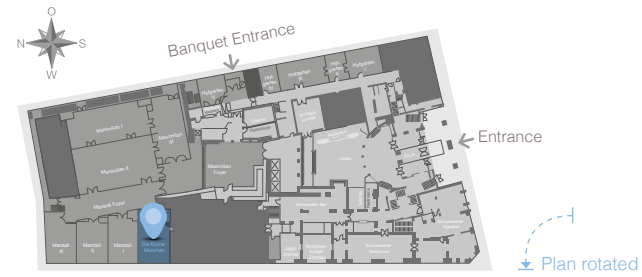

**NUMBER OF GUESTS**



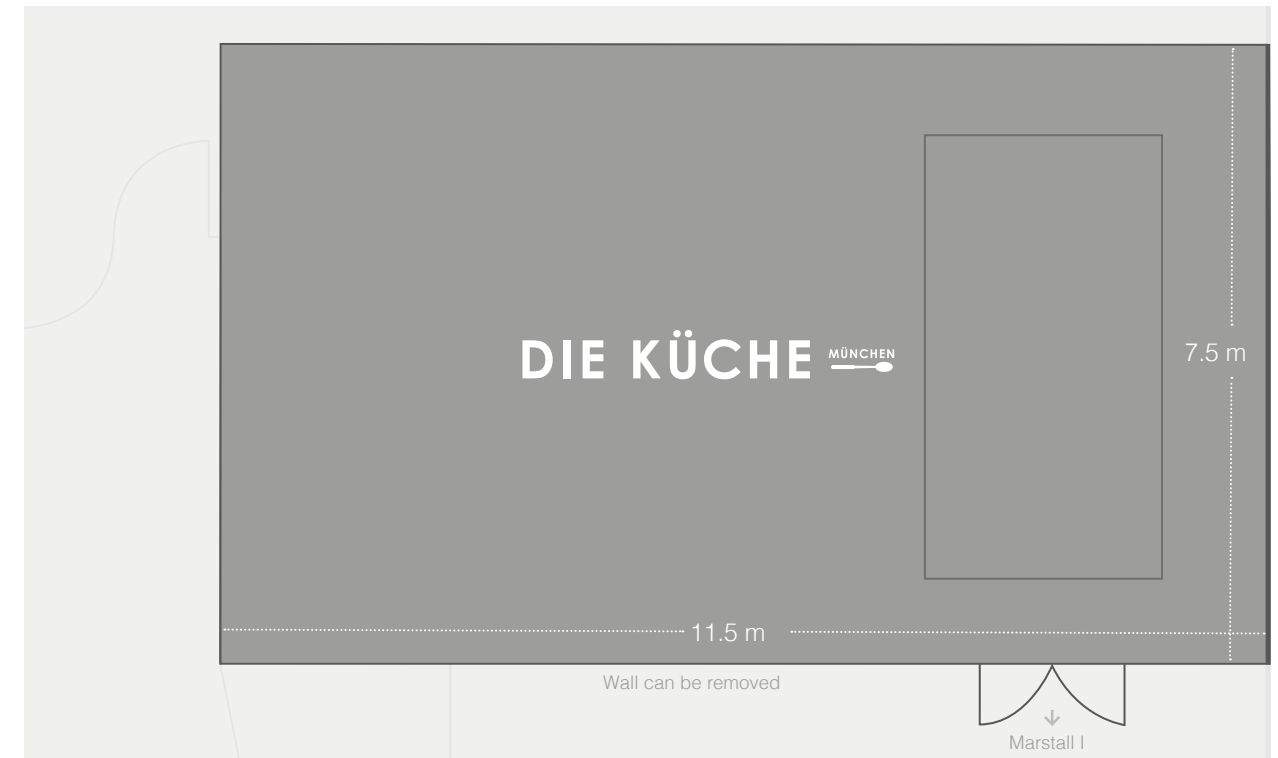



For up to 25 guests, your kitchen party will take place in 'Die Küche München'. For more than 25 guests, we will enlarge the space by adding the adjacent rooms.



**Die Küche München**



**INFORMATION**

|  |   |            |    |
|--|---|------------|----|
|  | sqm   | 85         |    |
|  | length x width  | 11.5 x 7.5 |    |
|  | height  | 2.85       |    |
|  |  | Theatre    |    |
|  |  | Classroom  |    |
|  |  | Banquet    |    |
|  |  | Cabaret    |    |
|  |  | Board Room |    |
|  |  | U-Style    |    |
|  |  | Reception  | 50 |



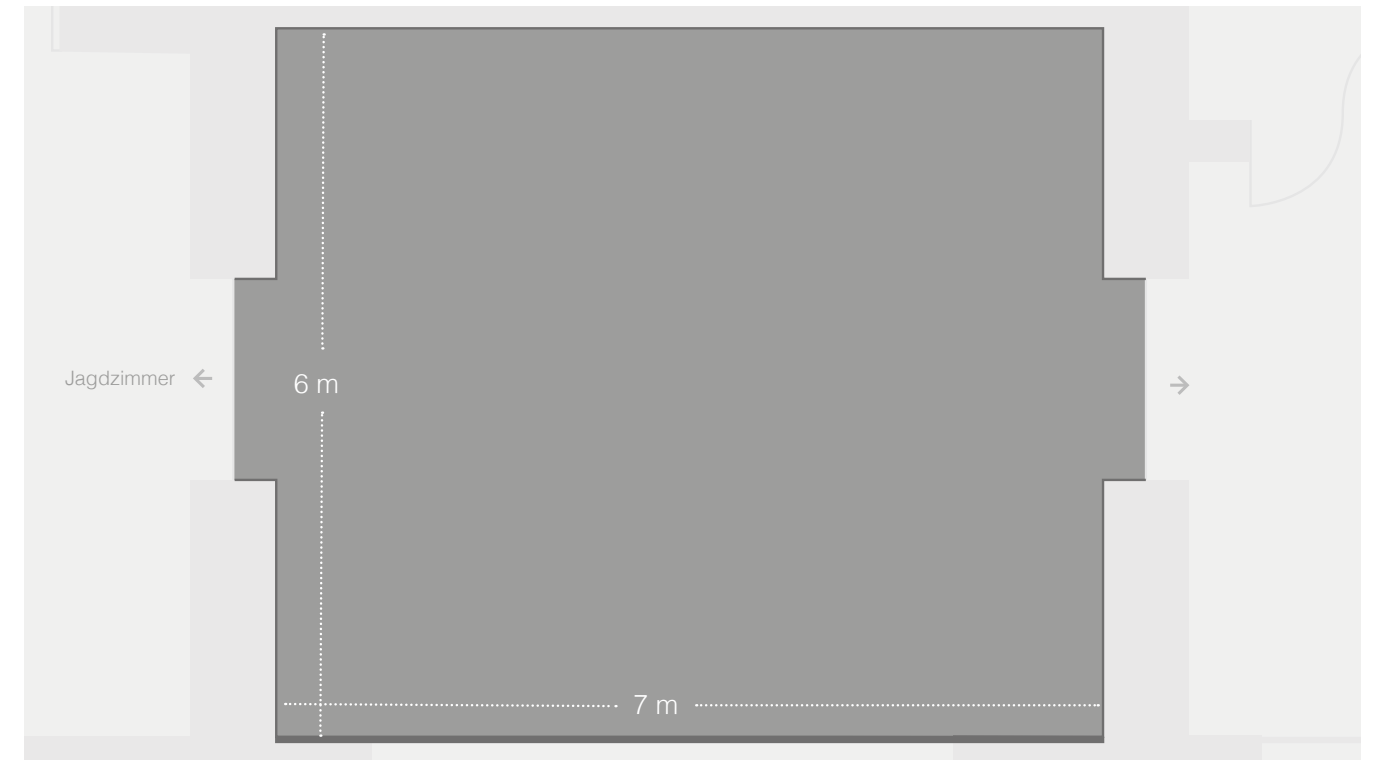
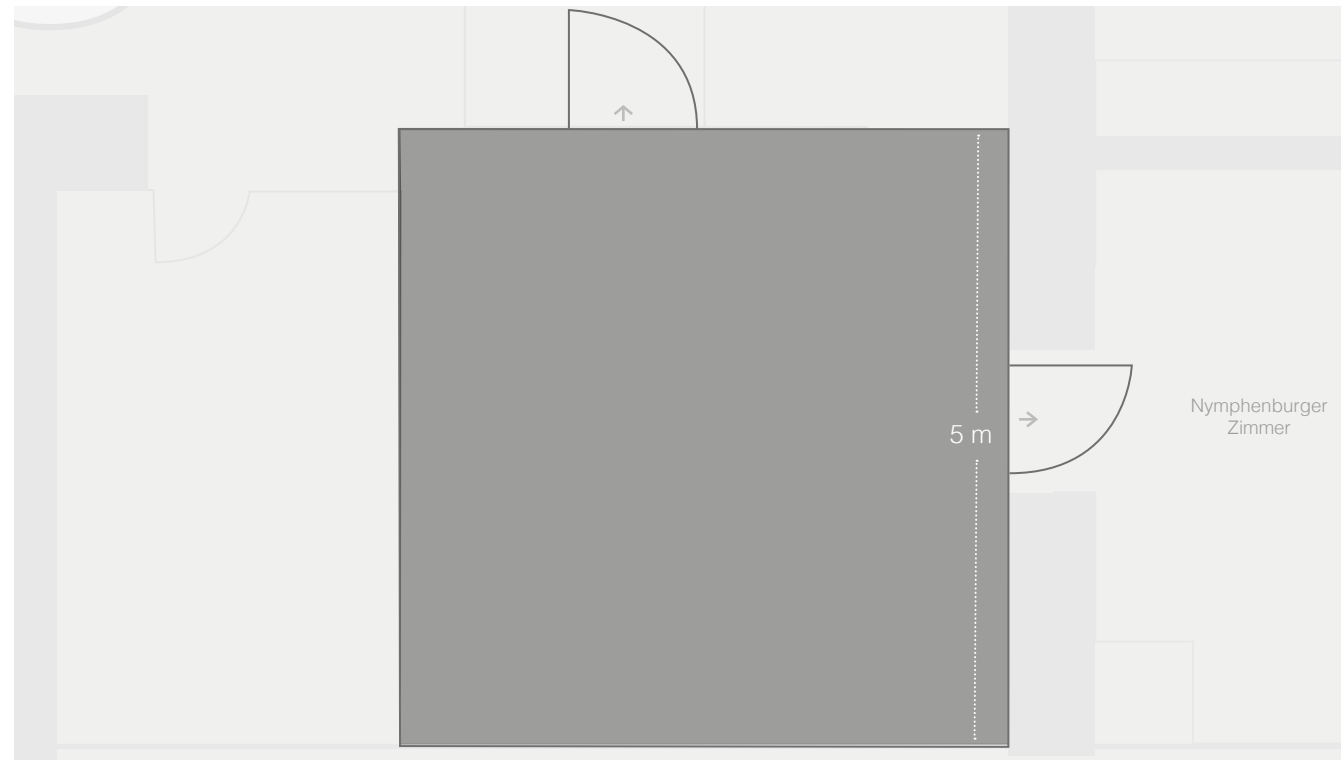
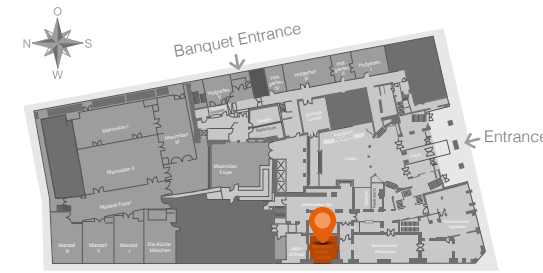
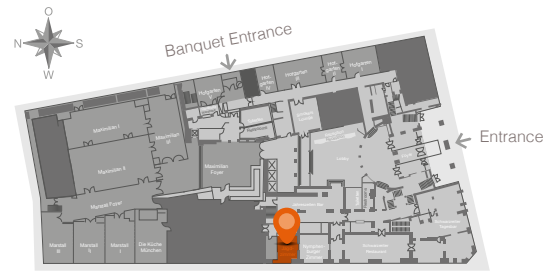

## Jagdzimmer



### INFORMATION

|  |                |       |  |
|--|----------------|-------|--|
|  | sqm            | 25    |  |
|  | length x width | 5 x 5 |  |
|  | height         | 3.3   |  |
|  | Theatre        |       |  |
|  | Classroom      |       |  |
|  | Banquet        |       |  |
|  | Cabaret        |       |  |
|  | Board Room     | 12    |  |
|  | U-Style        |       |  |
|  | Reception      |       |  |

## Nymphenburger Zimmer

### INFORMATION

|  |                |       |  |
|--|----------------|-------|--|
|  | sqm            | 42    |  |
|  | length x width | 7 x 6 |  |
|  | height         | 3.3   |  |
|  | Theatre        |       |  |
|  | Classroom      |       |  |
|  | Banquet        |       |  |
|  | Cabaret        |       |  |
|  | Board Room     | 24    |  |
|  | U-Style        |       |  |
|  | Reception      |       |  |



## MEETINGS MADE EASY AND UNCOMPLICATED *with our Conference Packages*



Marshall Saal II



### FULL DAY

8am - 6pm

Including the following benefits:

- Room rental for the main meeting room
- 2 soft drinks
- Writing pads, pencils and mints
- High speed internet access
- 2 coffee breaks of your choice
- Working lunch of your choice served at cocktail tables
- 1 soft drink during lunch
- Coffee after lunch
- Technical equipment (projector, screen, sound system)



### HALF DAY

8am - 12noon or 1pm - 6pm

Including the following benefits:

- Room rental for the main meeting room
- 1 soft drink
- Writing pads, pencils and mints
- High speed internet access
- 1 coffee break with pastries of your choice
- Working lunch of your choice served at cocktail tables
- 1 soft drink during lunch
- Coffee after lunch
- Technical equipment (projector, screen, sound system)









# TAKE A BREAK ...

## *Our Break Specials*

Here you will find a choice of coffee break, buffet and menu options matched with seasonal ingredients. On request, we will send you a tailor-made offer.

.....

- »  **SPRING** »
-  **SUMMER** »
-  **AUTUMN** »
-  **WINTER**

.....



*Please click on the current season and learn more about our offers.*

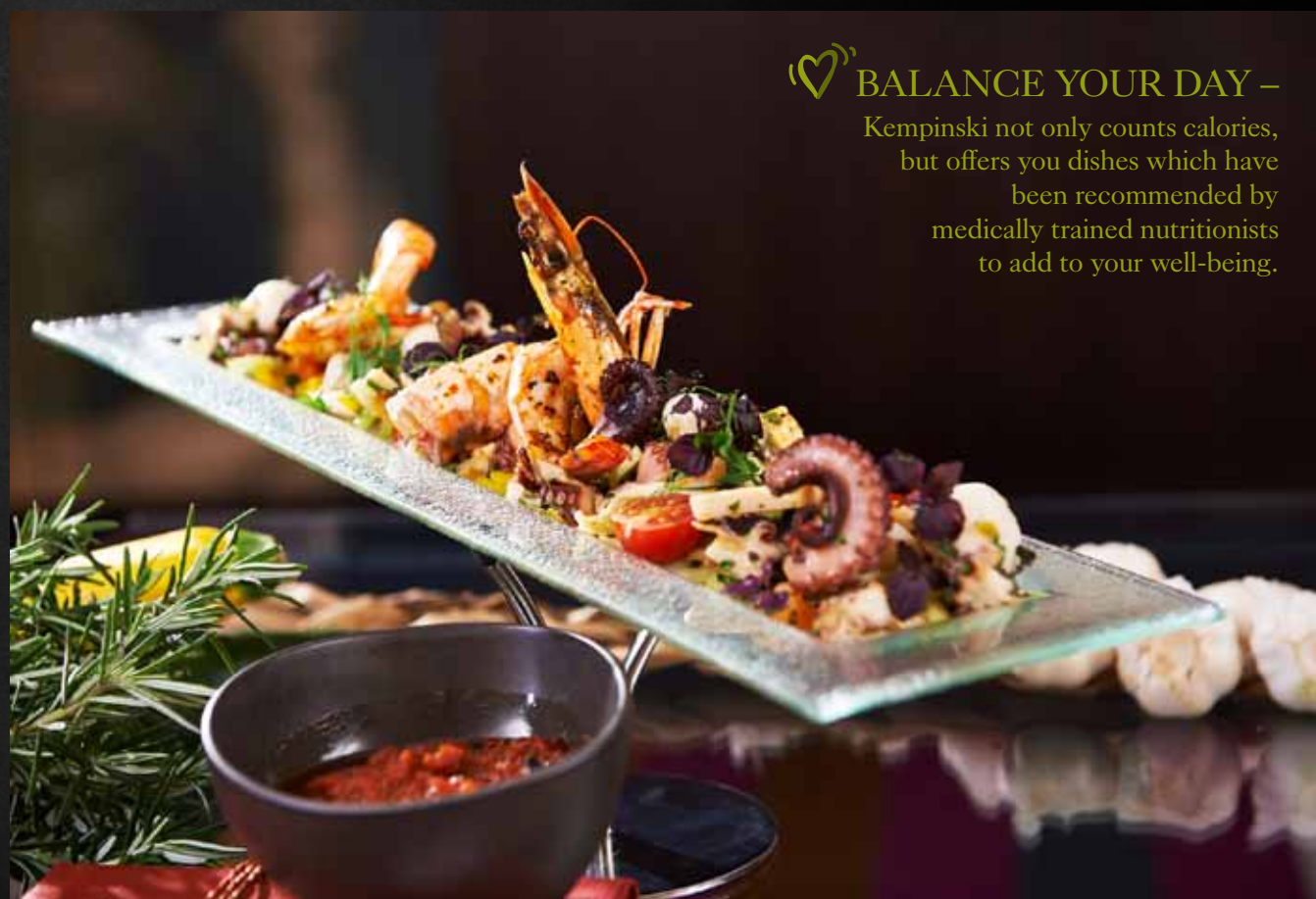

 **BALANCE YOUR DAY –**  
Kempinski not only counts calories,  
but offers you dishes which have  
been recommended by  
medically trained nutritionists  
to add to your well-being.







  
Hotel  
Vier Jahreszeiten  
Kempinski  
MÜNCHEN



**INDIVIDUAL & UNIQUE**

*- Our Rooms & Suites*



Our opulent rooms and suites reflect the perfect harmony of trend and tradition. The choice of twelve different room categories fascinate even the most discerning guest. Inspired by the glamorous era of Maximilian II, every room has been individually and uniquely designed.

**NUMBER OF ROOMS**

- 297 rooms incl.
- 67 suites

**BUSINESS SINGLE ROOM**



Modest elegance and timeless interior - an ideal retreat especially for discerning business travellers. 18sqm, queen-size bed, flat screen TV, working desk, shower

**SUPERIOR ROOM**



The light flooded superior rooms attract through their luxurious design and timeless elegance.

25sqm, king-size bed, flat screen TV, working desk, shower

**EXECUTIVE ROOM**



Our spacious executive rooms offer exquisite living comfort and are located in an historic wing of the hotel. 35-45sqm, king-size bed, flat screen TV, working desk, bathtub & shower

**DELUXE ROOM**



Warm colours, design orientated interior, fine fabrics as well as opulent ceiling canvases - these rooms are a mix of contemporary and tradition. 30-40sqm, king-size bed, flat screen TV, working desk, bathtub & shower

**CANVAS**

The corridors, ceilings and walls of the hotel's rooms and suites are decorated with elaborate canvases. The chosen masterpieces are part of the private collection of the Wittelbach family which are on display at the Pinakothek Munich. The paintings have been amplified, printed on canvases and installed exclusively at the Hotel Vier Jahreszeiten.





# The Suite Collection



## JUNIOR SUITE



Located in the historical wing overlooking either the inner courtyard or the side street, these traditional suites impress with their modest elegance. 55sqm, lounge area, bathtub & shower, working desk

## DELUXE JUNIOR SUITE



Baroque paintings adorn the ceilings of these suites and the design-led interior unite modern and antique furnishings. 50sqm, lounge area, bathtub & shower, working desk

## SUPERIOR SUITE



Breath-taking - our Superior Suites! Immerse yourself in a world that feels like home. 60sqm, king- or queen-sized bed, bathtub & shower, working desk

## EXECUTIVE SUITE



The elegant Executive Suites are located in the historical wing, and comprise a spacious living- and a separate bedroom. 80sqm, separate living- and bedroom

## DELUXE TWO BEDROOM SUITE



In these suites, enjoy and experience design elements from Philippe Starck, ceiling master pieces as well as a sophisticated interior. 96sqm, lounge area, separate living- and bedroom

## PENTHOUSE SUITE



Carefully chosen materials like silk and precious cherrywood adorn the generous living room of the Penthouse Suite creating an elegant flair. It also features a rooftop terrace with a view over the skyline of the old city. 180sqm, two bedrooms, own kitchen



**PRESIDENTIAL SUITE**



Precious woods, sophisticated fabrics and muted colours dominate the design of this exclusive suite.  
130sqm, separate living- and bedroom, dining room, lounge area, kitchenette

**ROYAL LUDWIG SUITE**



Furnished using sophisticated materials for an exclusive interior with calfskin flooring, unrivalled ceiling masterpieces and view over Maximilianstraße - this is what you can expect of Munich's most luxurious suite!  
Our General Manager Axel Ludwig will look after your booking personally.  
190sqm, Jacuzzi, sauna, private butler



Royal Ludwig Suite bathroom





Sven Büttner  
Executive Chef

Ian Baker  
Head Pastry Chef

Christian Michel  
Head Chef Schwarzreiter

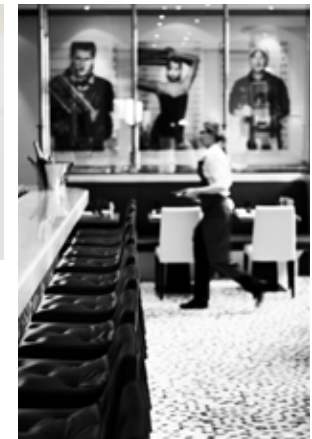

**DIFFERENT. YOUNGER. MORE INNOVATIVE.**  
*Our Taste Force!*

When Executive Chef Sven Büttner, Schwarzreiter's Head Chef Christian Michel and Chef Pâtissier Ian Baker pick exclusive ingredients from regional producers, they only have one objective in mind: to make our guests happy.

Love for quality, European handicraft and a healthy dose of creativity allow us to re-interpret old recipes and to turn innovative dishes into highlights.

At the Schwarzreiter Tagesbar & Restaurant as well as at the events area - we are looking forward to pampering you.





Schwarzreiter Tagesbar

**YOUNG BAVARIAN CUISINE**

*Schwarzreiter Tagesbar & Restaurant*

Besides a fascination for the Bavarian cuisine, we are inspired by the roots and traditions of Munich which were created mainly by the glamorous bon vivants and dandies like Ludwig II. At Schwarzreiter Tagesbar & Restaurant, we re-interpret Bavarian dishes as Young Bavarian Cuisine.

**OPENING HOURS**  
**SCHWARZREITER TAGESBAR:**  
 Daily: 12 noon - 12 midnight

**OPENING HOURS**  
**SCHWARZREITER RESTAURANT:**  
 Tuesday to Saturday: 6.30pm - 10.30pm



**NUMBER OF GUESTS PER ROOM**

|            |            |
|------------|------------|
| Tagesbar   | 68 persons |
| Restaurant | 44 persons |



Christian Michel, Head Chef  
 Schwarzreiter Tagesbar & Restaurant



Schwarzreiter Restaurant



Entrance Schwarzreiter





Ox-muzzle salad



Bavarian Crème





**THE LOBBY –**  
*Munich's Most Beautiful Living-Room*

**JAHRESZEITEN BAR & LOBBY**

The Lobby, lovingly called 'Munich's most beautiful living-room', offers an exceptional speciality. Tea sommelier Joel Belouet serves the traditional afternoon tea. Aromatic scones, delicious sandwiches and, of course, the finest tea turn this event into a very special experience.

|  |                              |
|--|------------------------------|
| <b>OPENING HOURS JAHRESZEITEN BAR:</b> | <b>OPENING HOURS LOBBY:</b>  |
| Monday to Friday: 11am - 1am           | Monday to Friday: 8am - 1am  |
| Saturday & Sunday: 11am - 2am          | Saturday & Sunday: 8am - 2am |



Joel Belouet, Tea Master Gold

**IAN BAKER –**  
*Pâtissier of the Year 2015*

**... ALSO FOR TAKE-AWAY**

Still with the scent of his Mum's cakes and biscuits fresh in his nose, the then 16-year old resolutely pursued his career as Pâtissier. He learnt from a baking legend: David Avery, who famously created the wedding cake for Princess Diana and Prince Charles. Today, Ian creates sweet delicacies for our guests that conjure indulgent smiles at the hotel's Lobby, at events or at home.



Ian Baker, Head Pastry Chef & Pâtissier of the Year 2015







**WELLNESS**  
*for Your Senses!*

Stop for a while and find your inner peace at our Kempinski The Spa! Enjoy a wellness massage, relax in our spacious pool, workout using the latest fitness equipment or just lose yourself in the sensational view over the rooftops of Munich.

**OPENING HOURS:**  
Daily from 6.30am - 10.30pm

*Kempinski*  
The Spa







**24/7 – SERVICE**

*Without Time Limit*

Perhaps you need opera tickets or a table reservation at short notice? A button needs to be sewn back on or you are looking for an evening gown after hours? For us and our high service aspirations, this is not a problem...



**LADIES**  
*in Red*

The Ladies in Red play an important role at Kempinski and turn wishes into reality. They are the ambassadors and the extension of the general manager. To make your stay even more memorable, you can contact the ladies and gentlemen in red with all your requests and requirements.









## PLAN YOUR EXCEPTIONAL EVENTS

*with our competent Event Managers*



Our team of seven knowledgeable event managers, with extensive expertise, are available to assist you with your event. You will have one dedicated contact who will plan, execute and round up the event with you.

We are looking forward to planning your event with you and to making it an exceptional experience.

### > YOUR CONTACT PARTNERS



Daniel Döscher  
Director of Groups & Events  
T +49 89 2125 2207  
daniel.doescher@kempinski.com



Christina Barth  
Ass. Director of Groups & Events  
T +49 89 2125 2204  
christina.barth@kempinski.com



Katharina Biedermann  
Ass. Director of Groups & Events  
T +49 89 2125 2206  
katharina.biedermann@kempinski.com



Hotel Vier Jahreszeiten Munich  
Maximilianstraße 17  
80539 Munich  
Germany

T +49 89 2125 0  
F +49 89 2125 2720  
meetings.vierjahreszeiten@kempinski.com  
www.kempinski.com/vierjahreszeiten

GPS Long: 11.58200° E  
GPS Lat: 48.13912° N

**KEMPINSKI.COM**

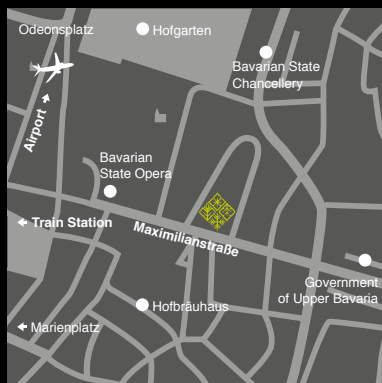

**PROPERTY CODES:**

APPOLLO/GALILEO: 09702  
SABRE: 13159  
AMADEUS: MUCKEM  
WORLDSPAN: MUC01  
PEGASUS: HYKMUCK1